

\$98,000 - 25, 47017 Highway 21, Rural Camrose County

MLS® #CA0180946

\$98,000

0 Bedroom, 0.00 Bathroom,
Commercial on 4.47 Acres

Ervick Industrial, Rural Camrose County,
Alberta

4.47 Acres of Industrial Land just West of Camrose within the Ervick Industrial Subdivision. The Ervick Rural Industrial Subdivision is strategically located with
• affordable • rural industrial lots within:-1 hour to the City of Edmonton-45 minutes to the Edmonton International Airport-40 minutes to the Nisku Industrial Park-5 minutes to the City of Camrose (steel pipe mill, pipe coating plants, agricultural service industries)

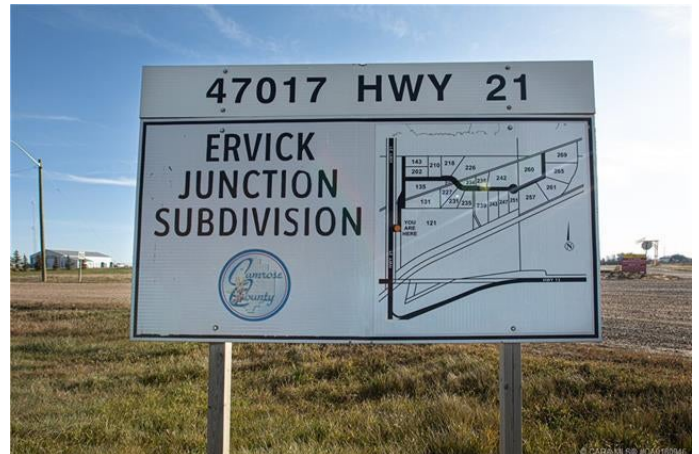

Essential Information

MLS® #	CA0180946
Price	\$98,000
Bathrooms	0.00
Acres	4.47
Type	Commercial
Sub-Type	Industrial
Status	Active

Community Information

Address	25, 47017 Highway 21
Subdivision	Ervick Industrial
City	Rural Camrose County
County	Camrose County
Province	Alberta
Postal Code	T4V 2M9

Additional Information

Date Listed	October 15th, 2019
Days on Market	2011
Zoning	Industrial

Listing Details

Listing Office	Coldwell Banker Battle River Realty
----------------	-------------------------------------

Data is supplied by Pillar 9â„¢ MLS® System. Pillar 9â„¢ is the owner of the copyright in its MLS® System. Data is deemed reliable but is not guaranteed accurate by Pillar 9â„¢. The trademarks MLS®, Multiple Listing Service® and the associated logos are owned by The Canadian Real Estate Association (CREA) and identify the quality of services provided by real estate professionals who are members of CREA. Used under license.